

FREE/COMBINED CHLORINE TEST PROCEDURE

The Free/Combined Chlorine test procedure utilizes the **STANDARD STRIP METHOD** using the eXact iDip® Smart Photometer System®. For tips on achieving best accuracy, and additional information regarding features of the eXact iDip® photometer and the eXact iDip® app, please refer to the eXact iDip® Quick Start Guide. You can download a copy on our website at sensitive.com/idip.

YOU WILL NEED

- eXact iDip® photometer
- Your smartphone/tablet with the eXact iDip® app installed
- (1) eXact® Strip Micro Free Chlorine (DPD-1) (Part no. 486637)
- (1) eXact® Strip Micro Combined Chlorine (DPD-3) (Part no. 486638)
- Water sample for rinsing and testing



1 SELECT CUSTOMER

- Select **Customers** from the Home screen.
- Choose customer from list
OR Tap **'Add customer from contacts'** and choose customer from your contacts list
OR Tap **'+'** to create a new customer

Android users: If no address is found, tap "No addresses found"

- Verify customer has been selected

Note: In order to take full advantage of the GPS and Data Storage features, each test result must be linked to a contact. Individual users may select their own contact listing.

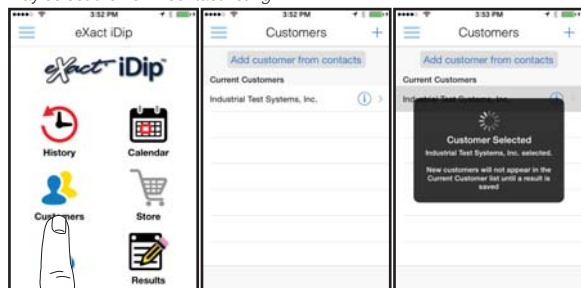

a

b

c

2 POWER ON EXACT IDIP®

Press the **ZERO/ON** button to power on the eXact iDip® photometer.

3 SELECT BLUETOOTH TEST

Tap the menu slide out **'≡'** and select **'Bluetooth Test'** from the choices shown.

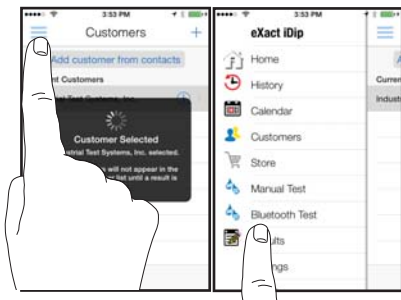

4 CONNECT EXACT IDIP®

The eXact iDip® app will automatically connect to the most recently used eXact iDip® photometer. If not, select your eXact iDip® from the bottom of the screen.

Note: Ensure you always connect your eXact iDip® photometer via the Bluetooth® connection within the app. If you experience an issue connecting your device, check to ensure that your smartphone/tablet's Bluetooth® function is turned on and your device is compatible.

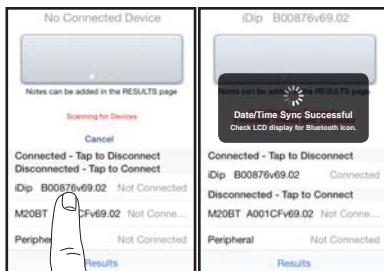

5 SELECT TEST

Tap **'SELECT Test'** at the top and select **Chlorine, Free/Combined/Total CL**. The eXact iDip® photometer and eXact iDip® app will both display the test selection for Free Chlorine.

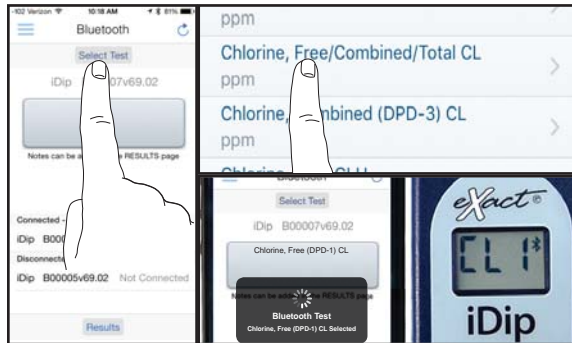

6 FILL CELL

Rinse the cell 3 times with the water sample to be tested, then **FILL** cell to capacity to begin test.



7 CAP CELL AND ZERO METER

Place the Cell Cover onto the CELL and press **ZERO/ON** and the eXact iDip® photometer display reads **0 PPM** indicating the meter is ready for testing.



8 REMOVE STRIP

Remove one eXact® Strip Micro Free Chlorine (DPD-1) (Part no. 486637) and set in a dry, convenient place. Replace cap on bottle.



9 REMOVE STRIP

Remove one eXact® Strip Micro Combined Chlorine (DPD-3) (Part no. 486638) and set in a dry, convenient place. Replace cap on bottle.



10 DIP STRIP

Press **READ** to initiate a 20 second countdown and simultaneously **DIP** the CL (DPD-3) test strip in the sample, gently touching the bottom of the cell. Use a gentle constant back and forth motion (2 strokes per second) until the timer displays "1". Remove and discard the strip.



11 CAP CELL AND READ RESULT

READ result displayed as Free Chlorine.

Important! Do not empty the CELL when testing for Combined Chlorine. You will need the sample.

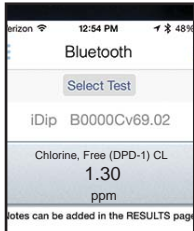

12 TAP OK

App will show 'Chlorine, Combined (DPD-3) CL Second Command Sent'. Tap **OK**. The eXact iDip® photometer and eXact iDip® app will both display the test for Combined Chlorine.

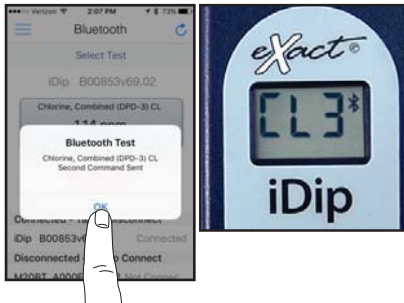

13 ZERO METER

With the sample from Free Chlorine test (step 11) still in the cell, Press **ZERO/ON** and the eXact iDip® photometer display reads 0PPM indicating the meter is ready to continue testing.



14 DIP STRIP

Press **READ** to initiate a 20 second countdown and simultaneously **DIP** the CL (DPD-3) test strip in the sample, gently touching the bottom of the cell. Use a gentle constant back and forth motion (2 strokes per second) until the timer displays "1". Remove and discard the strip.

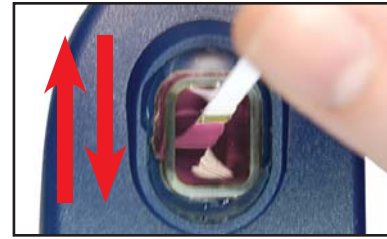

15 CAP CELL AND READ RESULTS

Place the Cell Cover onto the CELL and **READ** result displayed as Combined Chlorine.

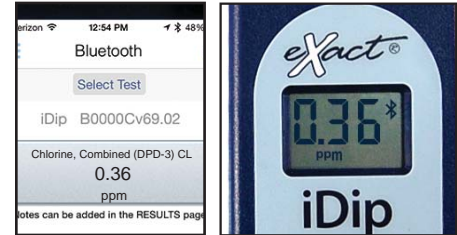

16 CLEAN CELL WITH BRUSH

After testing, rinse CELL immediately and clean with brush to remove reagents which coat the CELL wall.



TIPS

- To get final result as Total Chlorine, add the Free Chlorine and Combined Chlorine values together (ex. 1.30ppm + 0.36ppm = 1.66ppm Total Chlorine). The app will do this automatically in Results section.
- DPD-1 will react with other oxidizers including peroxide and ozone.

MANAGE YOUR RESULTS

Save, send, and share results instantly using the eXact iDip® app. For step-by-step instructions, refer to the eXact iDip® Quick Start Guide. You can download a pdf copy on-line at sensafe.com/idip.



eXact iDip

